

DESKTOP ROBOT / DTR series

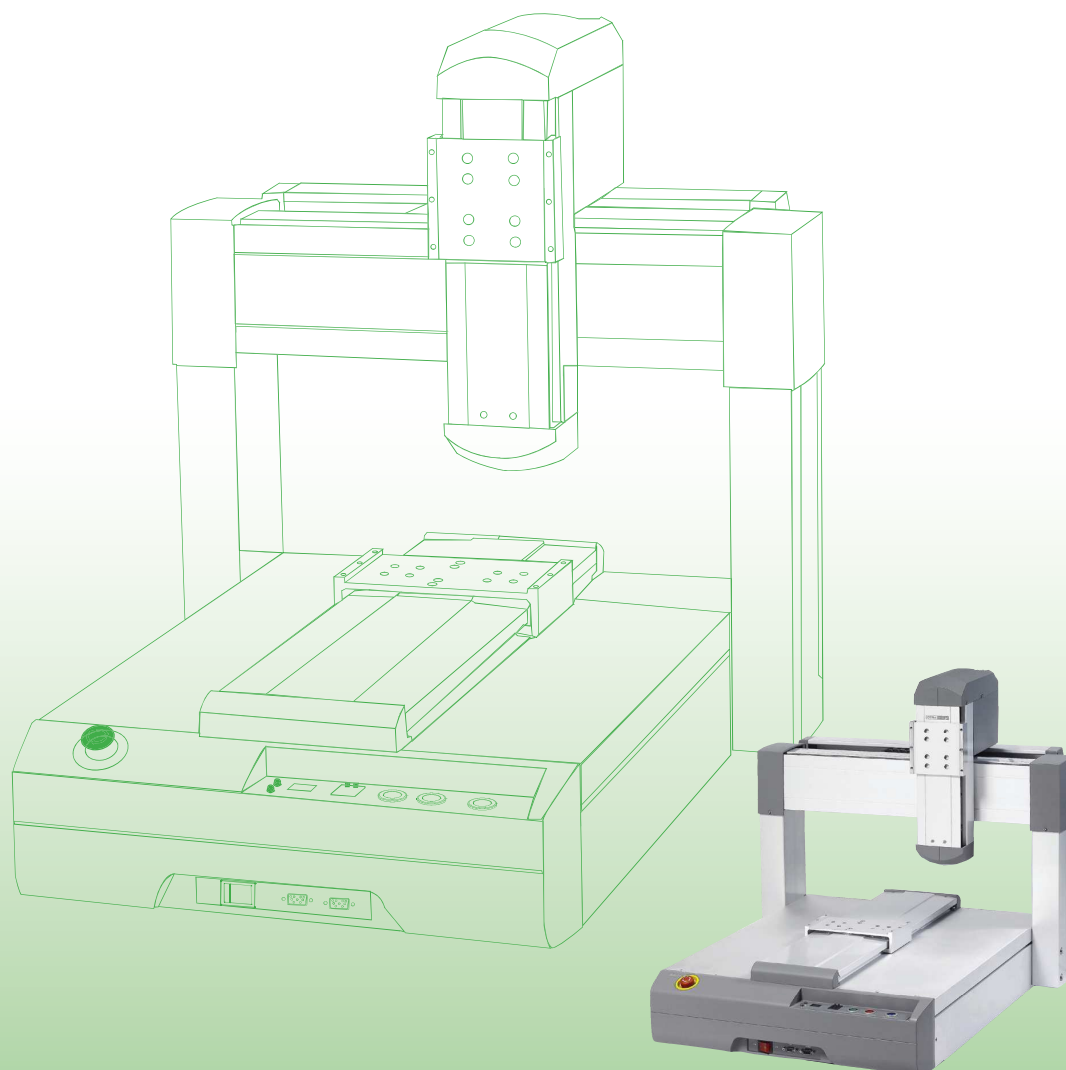

Contents

Feature	98
Ordering Model	99
Model List	99
DTR series Note	100
Specification of DTR-M, T Series	101 _ 102
Specification of DTR-ET Series	103 _ 104
Specification of DTR-S Series	105 _ 106

Feature

DTR series are designed to combine high precision and accurate positioning functions into compact unit with high rigid structure. DTR series have various models of servo motor with ball screw types and step motor with belt types models of and they are very useful and achieve best performance and outstanding cost performance

High Rigid Structure

Aluminum extruded material is employed on the base and gantry structure for all models enhance rigidity. The servo motor and ball screw types of DTR are a good solution for the required applications of high load such as automotive industry

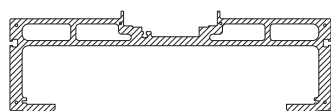

(Cross-sectional view of DTR series)

Various line-up

The DTR series provide various products ranges. Belt driven with Encoder Stepper Motor type, belt driven with Stepper Motor type, ballscrew drive with Servo Motor type, 2 axes, 3 axes, 4 axes, and Dual-X axes are available.

Compact design

Minimize whole dimension by cable treatment into the Robot and save working space*



DTR2(3)-3310/4410-T(ET,S)



DTR4-3510-S series



DTR3-2210-T(ET) series

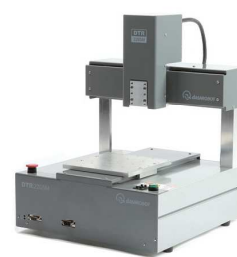

DTR3-2205-M series

* Cables of the model 2205/2210 series and 4 axes (XYZR) of DTR series are exposed

Wide variety of applications

General purpose of software "iM-Σ" and PC software "Dawin-Pro" extends user's particular working job range, such as Screw tightening, Soldering, Dispensing, and CCD camera, Touch panel and other automation operations

Supporting Field network (Optional)

The DTR supports field network such as CC-Link, Device Net, ProfiBus and Ethernet

Large Memory Capacity

Up to 100 programs can be stored. Up to 100,000 position points can be stored.

Ordering Model

① Series	② Axis	③ Stroke	④ Drive	⑤ Option
DTR	3	- 3310	- S	- SG

① Series

Name of the series : DTR is Desktop Robot

② Axis

Number of axis

2 : 2 axes (XY)

3 : 3 axes (XYZ)

4 : 4 axes (XYZR / X1X2YZ)

③ Stroke

XYZ stroke

2205 : 200×200×50mm(XYZ)

2210 : 200×200×100mm(XYZ)

3310 : 300×300×100mm(XYZ)

4410 : 400×400×100mm(XYZ)

3510 : 300×300×500×100mm(X1X2YZ)

* Stroke 3510 model is a Dual-x axes type

④ Drive

Drive types

S : Servo motor & Ball screw type

T : Stepper motor & Belt type

ET : Encoder Stepper motor & Belt Type

M : Mini Type, Stepper motor & Belt Type

* Standard specification of Z axis of S and T and ET Type is applied a brake motor

⑤ Option

The options to be equipped on the robot.

SG : iM-Σ software for general purpose

EZ : iM-EZ software for dispensing

TZ : iM-TZ software for screw tightening

EIO : Extend I/O (24/32)

EY : Extend the height up to 100mm

P : Add a MPG connector

Model List

Series	Drive	Model	Series				Allowable axis
			X axis	Y axis	Z axis	R axis	
DTR	Belt & Stepper motor	2205	200	200	50	-	3 axes(XYZ)
		2210					2 axes(XY)
		2210	200	200	100	-	3 axes(XYZ)
		3310					2 axes(XY)
		3310	300	300	100	+/-360°	3 axes(XYZ)
		3310					4 axes(XYZR)
		4410					2 axes(XY)
		4410	400	400	100	+/-360°	3 axes(XYZ)
		4410					4 axes(XYZR)
	Belt & Encoder Stepper motor	2210					2 axes (XY)
		2210	200	200	100	-	3 axes (XYZ)
		3310					2 axes (XY)
		3310	300	300	100	+/-360°	3 axes (XYZ)
		3310					4 axes (XYZR)
		4410					2 axes (XY)
		4410	400	400	100	+/-360°	3 axes (XYZ)
		4410					4 axes (XYZR)
	Ball screw & Servo motor	3310					2 axes(XY)
		3310	300	300	100	+/-360°	3 axes(XYZ)
		3310					4 axes(XYZR)
		4410					2 axes(XY)
		4410	400	400	100	+/-360°	3 axes(XYZ)
		4410					4 axes(XYZR)
		3510	300/300	500	100	-	4 axes(X1X2YZ)

DTR series Note

Desktop Robot

(Note 1) Maximum payload

The allowable payload of each axis of Desktop robot is different. The 'Work' represents the payload of X axis and Y axis and 'Tool' represents the payload of Z axis at 3 axes, and R axis at 4 axes.
"Maximum payload" is subject to change by the available speed.
Desktop 로봇의 각 축 별 허용 가반 하중은 다릅니다. 'Work'는 X축 또는 Y축을 뜻하며, 'Tool'은 3축의 경우 Z축을 4축의 경우 R축을 나타냅니다. "최대 가반 하중"은 사용 속도에 따라 바뀔 수 있습니다.

(Note 2) Positioning repeatability

This repeatability is not the "absolute positioning accuracy". It refers to the positioning accuracy of repeated movements to a prestored position.
반복정밀도는 "절대 위치 정밀도"가 아닙니다. 반복정밀도는 기 저장된 위치에 대한 반복된 이동의 위치 정밀도를 말합니다.

(Note 3) Drive type

A ball screw is applied to the Z axis of the belt driven type for higher precision.
높은 정밀도를 위하여 Belt type의 Z축은 Ball screw가 적용되었습니다.

(Note 4) Motor

A brake motor is applied to the Z axis of all models of DTR series.
DTR 시리즈 전 모델은 Z축에 Brake motor가 적용되었습니다.

(Note 5) Base material

All models of DTR series are made of high rigid aluminum extrusion and gantry types. Gantry type improves stability of the unbalanced load on the Y axis.
Models of aluminum material is available to increase the height of Y axis up to 100mm.
DTR 시리즈는 고 강성의 알루미늄 압출 및 Gantry 구조로 만들어졌습니다. Gantry 구조는 Y축의 안정성을 향상시켰습니다. Y축은 100mm까지 높일 수 있습니다.
〈Caution!〉 The base material of Dual-X axes model is made of aluminum casting.
Therefore, this model can not change the height of Y axis.
〈주의〉 Dual X 모델은 주물 소재로 만들어졌습니다. 따라서 이 모델은 Y축 높이 조정이 불가 합니다.

(Note 6) Power source

All Models except the Dual-X and DTR3-2205M are free voltage with 100~230VAC.
The Dual-X and DTR3-2205M model are possible for 200~230VAC.
Dual-X와 DTR3-2205M 모델을 제외한 전 모델은 100~230VAC 사용이 가능하며, Dual-X와 DTR3-2205M 모델은 200~230VAC만 가능합니다.

DRM series

DRMC series

DLM series

DTR series

DSM series

IMS-J series

IM-Z series

ACCESSORIES

RV series

Specification of DTR-M, T series

Item	Model	DTR3-2205-M	DTR2-2210T	DTR3-2210T	
	Number of axis	3	2	3	
Stroke(mm)	X, Y axis	200X200	200X200	200X200	
	Z axis	50	-	100	
	R axis	-	-	-	
Payload(kg)(Note1)	Work	5	5	5	
	Tool	2	5	3	
Speed(mm/s)	X, Y axis	500(5~500)	500(5~500)	500(5~500)	
	Z axis	250(2.5~250)	-	250(2.5~250)	
	R axis	-	-	-	
Repeatability(mm)	X, Y axis	±0.01	±0.01	±0.01	
	Z axis	±0.01	-	±0.01	
	R axis	-	-	-	
Dimension(mm)	W × D × H	320 X 320 X 410	395 X 487 X 453	395 X 487 X 607	
Weight(kg)		15	24	28	
Drive type(Note2)		Belt	Belt		
Motor(Note3)	Type	Stepper Motor / 2 Phase		Stepper Motor / 2 Phase	
	Operation	Micro Step		Micro Step	
Power source	Voltage/Frequency	AC220V(-15% ~ +10%) (single phase), 50/60Hz		AC100~230V(single phase), 50/60Hz	
	Capacity(VA)(Note4)	300[VA]		500[VA]	
Power amplifier	Input power[V]	48			
	Output power[A]	Max 1.5 per axis			
Program input		Teaching Pendant(DX-Σ), PC(IBM compatible)			
Position data input		MDI(Manual Data Input), Direct teaching, Touch panel			
Motion control		PTP, CP(3dimensional straight line/circular arc interpolation)			
Program capacity(Note5)	Point Files	100 files			
	Points	1,000 points per file			
PLC command		20 sets(AND, OR, NOT, TIMER, COUNTER etc.)			
Serial communicaiton		RS232C(19,200bps), RS422/RS232C(9,600 to 38,400bps)			
I/O(Input/Output)		Standard: 8(IN)/16(OUT), Extension(optional):24(IN)/32(OUT)			
Special functions		“3 dimensional palletizing, Pass&Turning motion, Teaching points shift, I/O parallel processing, R axis value compensation, Real time speed over ride”			
PLC scanning time(ms)		5			
User memory capacity		512kb			
User memory backup		FRAM			
Operating ambient temperature/humidity		0~45°C/20~80%RH			
Storage ambient temperature/humidity		-15~60°C/10~90%RH			

(Note 1) Maximum payload is subject to change by the available speed and operating conditions

(Note 2) Z axis is equipped with a ball screw (Φ10, Lead 10mm)

(Note 3) A brake motor is used for the standard specification of Z axis

(Note 4) The power capacity is base on 3 axes and is subject to change by number of axis

(Note 5) Motion program and point can not exceed the user memory capacity

	DTR2-3310T	DTR3-3310T	DTR4-3310T	DTR2-4410T	DTR3-4410T	DTR4-4410T
	2	3	4	2	3	4
	300X300	300X300	300X300	400X400	400X400	400X400
	-	100	100	-	100	100
	-	-	±360°	-	-	±360°
	10	10	10	10	10	10
	10	6	2	10	6	2
	500(5~500)	500(5~500)	500(5~500)	500(5~500)	500(5~500)	500(5~500)
	-	250(2.5~250)	250(2.5~250)	-	250(2.5~250)	250(2.5~250)
	-	-	600°/sec(6~600°)	-	-	600°/sec(6~600°)
	±0.01	±0.01	±0.01	±0.01	±0.01	±0.01
	-	±0.01	±0.01	-	±0.01	±0.01
	-	-	±0.02(°)	-	-	±0.02(°)
	630 X 678 X 613	630 X 678 X 813	630 X 678 X 813	730 X 778 X 613	730 X 778 X 813	730 X 778 X 813
	59	62	66	67	70	74
	Belt					
	Stepper Motor / 2 Phase					
	Micro Step					
	AC100~230V(single phase), 50/60Hz			AC100~230V(single phase), 50/60Hz		
	500[VA]			500[VA]		
	48			48		
	Max 1.5 per axis			Max 1.5 per axis		
	Teaching Pendant(DX-Σ), PC(IBM compatible)			Teaching Pendant(DX-Σ), PC(IBM compatible)		
	MDI(Manual Data Input), Direct teaching, Touch panel			MDI(Manual Data Input), Direct teaching, Touch panel		
	PTP, CP(3dimensional straight line/circular arc interpolation)			PTP, CP(3dimensional straight line/circular arc interpolation)		
	100 files			100 files		
	1,000 points per file			1,000 points per file		
	20 sets(AND, OR, NOT, TIMER, COUNTER etc.)			20 sets(AND, OR, NOT, TIMER, COUNTER etc.)		
	RS232C(19,200bps), RS422/RS232C(9,600 to 38,400bps)			RS232C(19,200bps), RS422/RS232C(9,600 to 38,400bps)		
	Standard: 8(IN)/16(OUT), Extension(optional):24(IN)/32(OUT)			Standard: 8(IN)/16(OUT), Extension(optional):24(IN)/32(OUT)		
	"3 dimensional palletizing, Pass&Turning motion, Teaching points shift, I/O parallel processing, R axis value compensation, Real time speed over ride"			"3 dimensional palletizing, Pass&Turning motion, Teaching points shift, I/O parallel processing, R axis value compensation, Real time speed over ride"		
	5			5		
	512kb			512kb		
	FRAM			FRAM		
	0~45°C/20~80%RH			0~45°C/20~80%RH		
	-15~60°C/10~90%RH			-15~60°C/10~90%RH		

Specification of DTR-ET series

Item	Model	DTR2-2210-ET	DTR3-2210-ET	
	Number of Axis ^(Note1)	2	3	
Stroke(mm)	X, Y axis	200X200	200X200	
	Z axis	-	100	
	R axis	-	-	
Payload(kg) (Note 1)	Work	7	7	
	Tool	6	4	
Speed(mm/s)	X, Y axis	800(8~800)	800(8~800)	
	Z axis	-	400(4~400)	
	R axis	-	-	
Repeatability(mm)	X, Y axis	±0.01	±0.01	
	Z axis	-	±0.01	
	R axis	-	-	
Dimension(mm)	W X D X H	395 X 487 X 453	395 X 487 X 607	
Weight (kg)		24	28	
Drive Type ^(Note2)		Belt		
Motor ^(Note3)	Type	Encoder Stepper Motor / 2 Phase		
	Operation	Closed Loop Constant Current PWM control		
Power source	Voltage/Frequency	AC220V(-15% ~ +10%) (single phase), 50/60Hz		
	Capacity(kva) ^(Note4)	500[VA]		
Power amplifier	Input power[V]	48		
	Output power[A]	Max 2 per axis		
Program input		Teaching Pendant(DX-Σ), PC(IBM compatible)		
Position data input		MDI(Manual Data Input), Direct teaching, Touch panel		
Motion control		PTP, CP(3dimensional straight line/circular arc interpolation)		
Program capacity ^(Note5)	Point Files	100 files		
	Points	1,000 points per file		
PLC command		20 sets(AND, OR, NOT, TIMER, COUNTER etc.)		
Serial communicaiton		RS232C(19,200bps), RS422/RS232C(9,600 to 38,400bps)		
I/O(Input/Output)		Standard: 8(IN)/16(OUT), Extension(optional):24(IN)/32(OUT)		
Special functions		"3 dimensional palletizing, Pass&Turning motion, Teaching points shift, I/O parallel processing, R axis value compensation, Real time speed over ride"		
PLC scanning time(ms)		5		
User memory capacity		512kb		
User memory backup		FRAM		
Operating ambient temperature/humidity		0~45°C/20~80%RH		
Storage ambient temperature/humidity		-15~60°C/10~90%RH		

(Note 1) Maximum payload is subject to change by the available speed and operating conditions

(Note 2) Z axis is equipped with a ball screw (Φ10, Lead 10mm)

(Note 3) A brake motor is used for the standard specification of Z axis

(Note 4) The power capacity is base on 3 axes and is subject to change by number of axis

(Note 5) Motion program and point can not exceed the user memory capacity

	DTR2-3310-ET	DTR3-3310-ET	DTR4-3310-ET	DTR2-4410-ET	DTR3-4410-ET	DTR4-4410-ET
	2	3	4	2	3	4
	300X300	300X300	300X300	400X400	400X400	400X400
	-	100	100	-	100	100
	-	-	±360°	-	-	±360°
	12	12	12	12	12	12
	12	7	3	12	7	3
	800(8~800)	800(8~800)	800(8~800)	800(8~800)	800(8~800)	800(8~800)
	-	400(4~400)	400(4~400)	-	400(4~400)	400(4~400)
	-	-	720°/sec(7.2~720°)	-	-	720°/sec(7.2~720°)
	±0.01	±0.01	±0.01	±0.01	±0.01	±0.01
	-	±0.01	±0.01	-	±0.01	±0.01
	-	-	±0.02(°)	-	-	±0.02(°)
	630 X 678 X 613	630 X 678 X 813	630 X 678 X 813	730 X 778 X 613	730 X 778 X 813	730 X 778 X 813
	59	62	66	67	70	74
	Belt			Belt		
	Encoder Stepper Motor / 2 Phase			Encoder Step motor / 2 phase		
	Closed Loop Constant Current PWM control			Closed Loop Constant Current PWM control		
	AC220V(+15% ~ +10%) (single phase), 50/60Hz			AC220V(+15% ~ +10%) (single phase), 50/60Hz		
	500[VA]			500[VA]		
	48			48		
	Max 2 per axis			Max 2 per axis		
	Teaching Pendant(DX-Σ), PC(IBM compatible)			Teaching Pendant(DX-Σ), PC(IBM compatible)		
	MDI(Manual Data Input), Direct teaching, Touch panel			MDI(Manual Data Input), Direct teaching, Touch panel		
	PTP, CP(3dimensional straight line/circular arc interpolation)			PTP, CP(3dimensional straight line/circular arc interpolation)		
	100 files			100 files		
	1,000 points per file			1,000 points per file		
	20 sets(AND, OR, NOT, TIMER, COUNTER etc.)			20 sets(AND, OR, NOT, TIMER, COUNTER etc.)		
	RS232C(19,200bps), RS422/RS232C(9,600 to 38,400bps)			RS232C(19,200bps), RS422/RS232C(9,600 to 38,400bps)		
	Standard: 8(IN)/16(OUT), Extension(optional):24(IN)/32(OUT)			Standard: 8(IN)/16(OUT), Extension(optional):24(IN)/32(OUT)		
	"3 dimensional palletizing, Pass&Turning motion, Teaching points shift, I/O parallel processing, R axis value compensation, Real time speed over ride"			"3 dimensional palletizing, Pass&Turning motion, Teaching points shift, I/O parallel processing, R axis value compensation, Real time speed over ride"		
	5			5		
	512kb			512kb		
	FRAM			FRAM		
	0~45°C/20~80%RH			0~45°C/20~80%RH		
	-15~60°C/10~90%RH			-15~60°C/10~90%RH		

Specification of DTR-S series

Item	Model	DTR2-3310S	DTR3-3310S	DTR4-3310S	
	Number of Axis	2	3	4	
Stroke(mm)	X, Y axis	300 × 300	300 × 300	300 × 300	
	Z axis	-	100	100	
	R axis	-	-	±360°	
Payload(kg)	Work	15kg	15kg	15kg	
	Tool	15kg	7kg	2kg	
Speed(mm/s)	X, Y axis	500(5~500)	500(5~500)	500(5~500)	
	Z axis	-	250(2.5~250)	250(2.5~250)	
	R axis	-	-	600°/sec(6~600°)	
Repeatability(mm)	X, Y axis	±0.01	±0.01	±0.01	
	Z axis	-	±0.01	±0.01	
	R axis	-	-	±0.02°	
Dimension(mm)	W × D × H	630 × 678 × 613	630 × 678 × 813	630 × 678 × 813	
Weight(kg)		62	67	71	
Drive type(Note2)		Ball screw			
Motor(Note3)	Type	AC Servo motor (Power : max 100[W])			
	Operation	3-phase PWM drive			
Power source	Voltage/Frequency	AC100~230V(single phase), 50/60Hz			
	Capacity(VA)(Note4)	Maximum 800[VA]			
Program input		Teaching Pendant(DX-Σ), PC(IBM compatible)			
Position data input		MDI(Manual Data Input), Direct teaching, Touch panel			
Motion control		PTP, CP(3dimensional straight line/circular arc interpolation)			
Program capacity(Note5)	Point Files	100 files			
	Points	1,000 points per file			
PLC command		20 sets(AND, OR, NOT, TIMER, COUNTER etc.)			
Serial communication		RS232C(19,200bps), RS422/RS232C(9,600 to 38,400bps)			
I/O(Input/Output)		Standard: 8(IN)/16(OUT), Extension(optional) : 24(IN)/32(OUT)			
Special functions		3 dimensional palletizing, Pass&Turning motion, Teaching points shift, I/O parallel processing, R axis value compensation, Real time speed over ride			
PLC scanning time(ms)		5			
User memory capacity		512kb			
User memory backup		FRAM			
Operating ambient temperature/humidity		0~45°C/20~80%RH			
Storage ambient temperature/humidity		-15~60°C/10~90%RH			

(Note1) The model DTR4-3510S is Dual X axes type with the stroke of 300×300×500×100mm(X1X2YZ)

(Note2) Maximum payload is subject to change by the available speed and operating conditions

(Note3) A brake motor is used for the standard specification of Z axis

(Note4) The power capacity is based on 3 axes and is subject to change by number of axis

(Note5) Motion program and point program can not exceed the user memory capacity

	DTR2-4410S	DTR3-4410S	DTR4-4410S	DTR4-3510S
	2	3	4	4
	400 × 400	400 × 400	400 × 400	300×500 (Note1)
	-	100	100	100
	-	-	±360°	-
	15kg	15kg	15kg	15kg
	15kg	7kg	2kg	7kg
	500(5~500)	500(5~500)	500(5~500)	500(5~500)
	-	250(2.5~250)	250(2.5~250)	250(2.5~250)
	-	-	600°/sec(6~600°)	-
	±0.01	±0.01	±0.01	±0.01
	-	±0.01	±0.01	±0.01
	-	-	±0.02°	-
	730 × 778 × 613	730 × 778 × 813	730 × 778 × 813	860 × 711 × 781
	70	75	79	82
	Ball screw			
	AC Servo motor (Power : max 100[W])			
	3-phase PWM drive			
	AC100~230V(single phase), 50/60Hz			
	Maximum 800[VA]			
	Teaching Pendant(DX-Σ), PC(IBM compatible)			
	MDI(Manual Data Input), Direct teaching, Touch panel			
	PTP, CP(3dimensional straight line/circular arc interpolation)			
	100 files			
	1,000 points per file			
	20 sets(AND, OR, NOT, TIMER, COUNTER etc.)			
	RS232C(19,200bps), RS422/RS232C(9,600 to 38,400bps)			
	Standard: 8(IN)/16(OUT), Extension(optional) : 24(IN)/32(OUT)			
	3 dimensional palletizing, Pass&Turning motion, Teaching points shift, I/O parallel processing, R axis value compensation, Real time speed over ride			
	5			
	512kb			
	FRAM			
	0~45°C/20~80%RH			
	-15~60°C/10~90%RH			

DTR3-2205M

Belt driven, Stroke 200x200x50, 3axes(XYZ), Aluminum Extrusion, Stepper Motor

Type : Stepper Motor

Axis : XYZ

Payload : 5 kgf(Work) / 2 kgf(Tool)

Series

DTR

Axis

3

Stroke

2205

Type

M

Option

SG

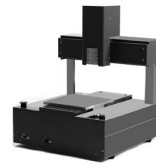

Basic specifications

Series	Axis	Stroke(mm)				Motor Type	Maximum Payload(Kg)(Note1)		Maximum Speed(mm/s)			
		X	Y	Z	R		Work	Tool	X	Y	Z	R
DTR	3	200	200	50	-	Stepper motor	5	2	500	500	250	-

Options

Code	Description
SG	Sigma software (General purpose)
EZ	Dispensing software
TZ	Screw fastening software
EIO	Extend IO(24/32)

Common specifications

Positioning Repeatability(Note2)	±0.01mm
Drive Type (Note3)	Belt
Motor (Note4)	Stepper motor, 2 phase, micro step
Base Material (Note5)	Aluminum, Extrusion type
Power source (Note6)	AC220V[-15%~10%], Single Phase, 50/60Hz
Weight	15kg

Dimension

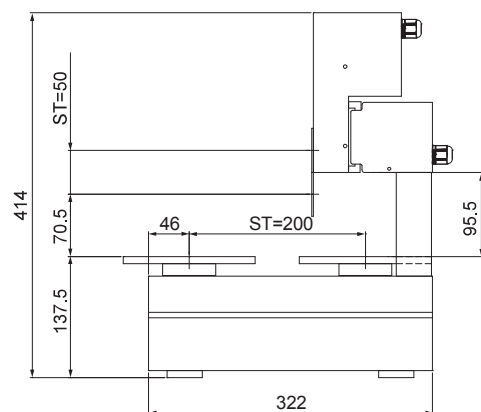
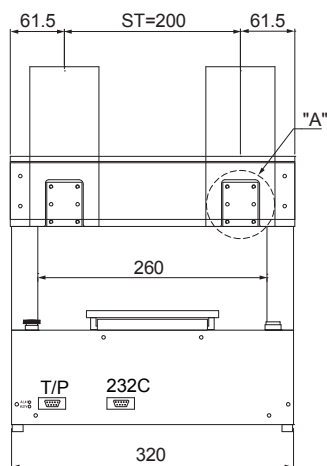
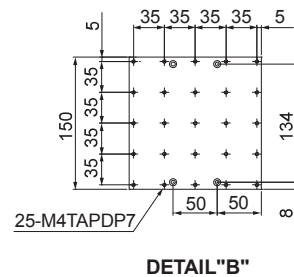
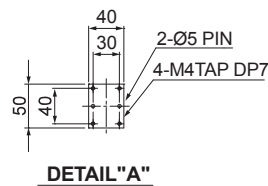
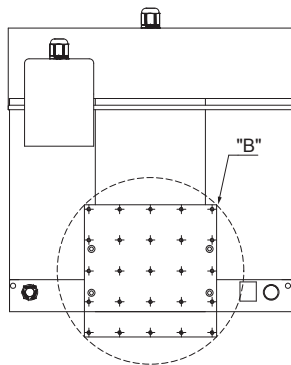

Applicable controllers

Controller	Maximum number of controlled axes	Page
Built-In	3 axes	157

Note

Refer to the page 100 for the detail explanations of (Note1) to (Note6)

DTR2-2210T	Belt driven, Stroke 200x200, 2axes(XY), Aluminum Extrusion, Stepper Motor			
DTR2-2210ET	Belt driven, Stroke 200x200, 2axes(XY), Aluminum Extrusion, Encoder Stepper Motor			
Type : Stepper Motor	Arm length : XY	Payload : 5 kgf(Work) / 5 kgf(Tool)		
Type : Encoder Stepper Motor	Arm length : XY	Payload : 7 kgf(Work) / 6 kgf(Tool)		
Series	Axis	Stroke	Type	Option
DTR	2	- 2210	- T	- SG

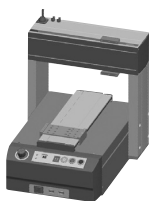

Basic specifications

Series	Axis	Stroke(mm)				Motor Type	Maximum Payload(Kg)(Note1)		Maximum Speed(mm/s)			
		X	Y	Z	R		Work	Tool	X	Y	Z	R
DTR-T	2	200	200	-	-	Stepper Motor	5	5	500	500	-	-
DTR-ET	2	200	200	-	-	Encoder Stepper motor	7	6	800	800	-	-

Options

Code	Description
SG	Sigma software (General purpose)
EZ	Dispensing software
TZ	Screw fastening software
EIO	Extend IO(24/32)
EY	Extended height of Y axis

Common specifications

Positioning Repeatability(Notes2)		±0.01mm
Drive Type (Notes3)		Belt at X, Y Axis
Motor (Notes4)	T Type	Stepper motor, 2 phase, micro step
	ET Type	Encoder Stepper Motor, 2 phase, micro step
Base Material (Notes5)		Aluminum, Extrusion type
Power source (Notes6)		100~230VAC, Single Phase, 50/60Hz
Weight		24Kg

Dimension

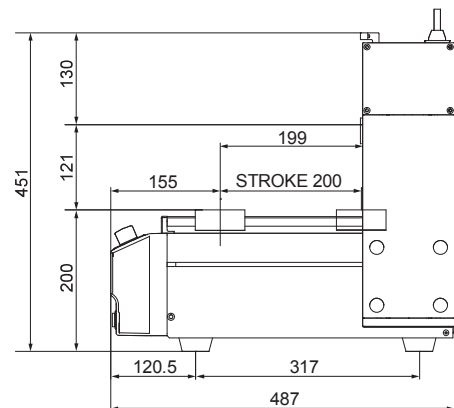
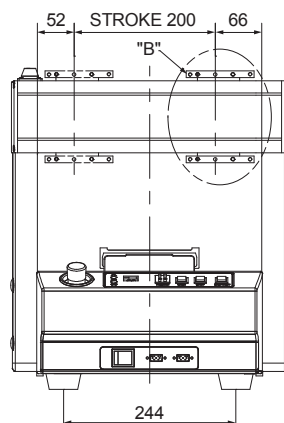
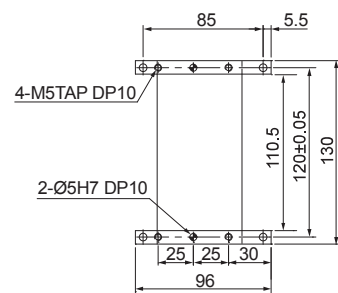
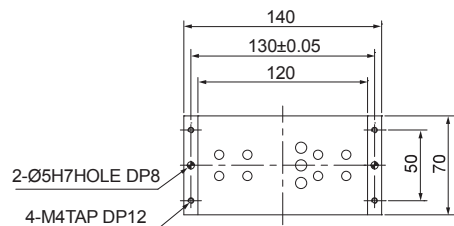
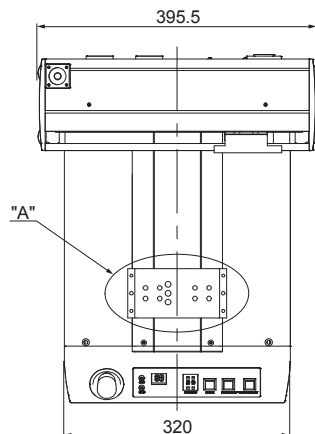

Applicable controllers

Controller	Maximum number of controlled axes	Page
Built-In	2 axes	157

Note

Refer to the page 100 for the detail explanations of (Note 1) to (Note 6)

DRM series

DRMC series

DLM series

DTR series

DSM series

IMS-J series

IMS-S series

ACCESSORIES

RV series

DTR3-2210T

Belt driven, Stroke 200x200x100, 3axes(XYZ), Aluminum Extrusion, Stepper Motor

DTR3-2210ET

Belt driven, Stroke 200x200x100, 3axes(XYZ), Aluminum Extrusion, Encoder Stepper Motor

Type : Stepper Motor Arm length : XYZ Payload : 5 kgf(Work) / 3 kgf(Tool)

Type : Encoder Stepper Motor Arm length : XYZ Payload : 7 kgf(Work) / 4 kgf(Tool)

Series	Axis	Stroke	Type	Option
DTR	3	2210	T	SG

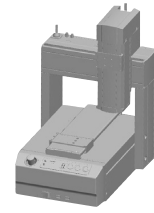

Basic specifications

Series	Axis	Stroke(mm)				Motor Type	Maximum Payload(Kg)(Note1)		Maximum Speed(mm/s)			
		X	Y	Z	R		Work	Tool	X	Y	Z	R
DTR-T	3	200	200	100	-	Stepper Motor	5	3	500	500	250	-
DTR-ET	3	200	200	100	-	Encoder Stepper motor	7	4	800	800	400	-

Options

Code	Description
SG	Sigma software (General purpose)
EZ	Dispensing software
TZ	Screw fastening software
EIO	Extend IO(24/32)
EY	Extended height of Y axis

Common specifications

Positioning Repeatability(Note2)		±0.01mm
Drive Type (Note3)		Belt at X, Y axis, Ballscrew at Z Axis(Φ15, Lead10)
Motor (Note4)	T Type	Stepper motor, 2 phase, micro step
	ET Type	Encoder Stepper Motor, 2 phase, micro step
Base Material (Note5)		Aluminum, Extrusion type
Power source (Note6)		100~230VAC, Single Phase, 50/60Hz
Weight		28Kg

Dimension

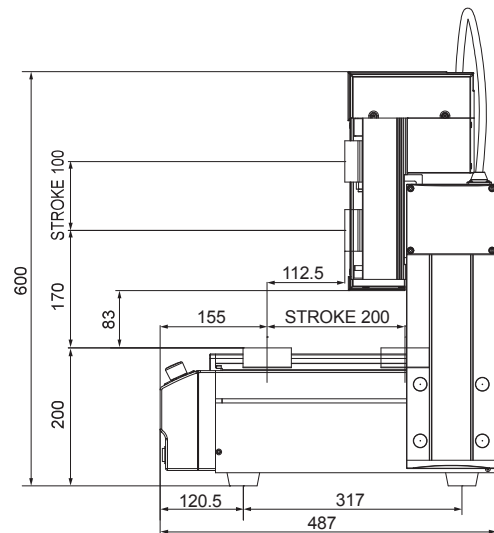
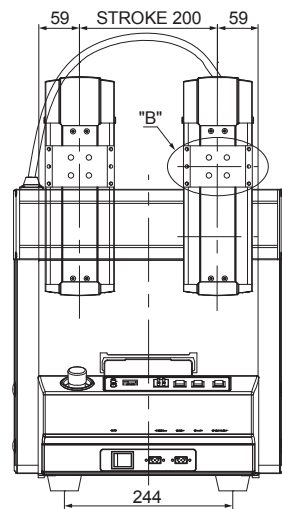
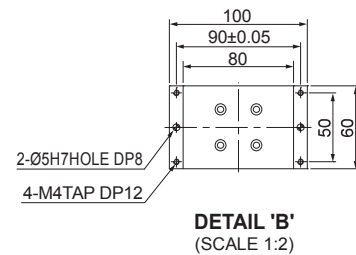
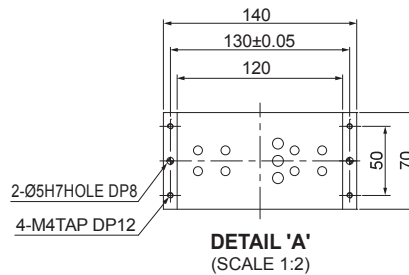
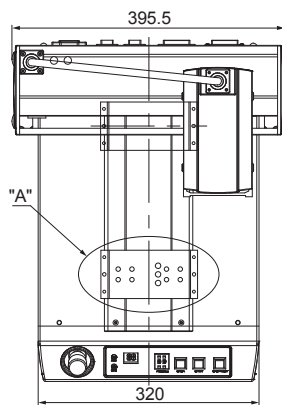

Applicable controllers

Controller	Maximum number of controlled axes	Page
Built-In	3 axes	157

Note

Refer to the page 100 for the detail explanations of (Note 1) to (Note 6)

DTR2-3310T	Belt driven, Stroke 300x300, 2axes(XY), Aluminum Extrusion, Stepper Motor			
DTR2-3310ET	Belt driven, Stroke 300x300, 2axes(XY), Aluminum Extrusion, Encoder Stepper Motor			
Type : Stepper Motor	Arm length : XY	Payload : 10 kgf(Work) / 10 kgf(Tool)		
Type : Encoder Stepper Motor	Arm length : XY	Payload : 12 kgf(Work) / 12 kgf(Tool)		
Series	Axis	Stroke	Type	Option
DTR	2	- 3310	- T	- SG

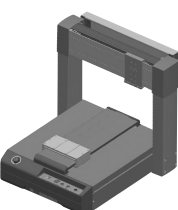

Basic specifications

Series	Axis	Stroke(mm)				Motor Type	Maximum Payload(Kg)(Note1)		Maximum Speed(mm/s)			
		X	Y	Z	R		Work	Tool	X	Y	Z	R
DTR-T	2	300	300	-	-	Stepper Motor	10	10	500	500	-	-
DTR-ET	2	300	300	-	-	Encoder Stepper motor	12	12	800	800	-	-

Options

Code	Description
SG	Sigma software (General purpose)
EZ	Dispensing software
TZ	Screw fastening software
EIO	Extend IO(24/32)
EY	Extended height of Y axis

Common specifications

Positioning Repeatability(Notes2)		±0.01mm
Drive Type (Notes3)		Belt at X, Y Axis
Motor (Notes4)	T Type	Stepper motor, 2 phase, micro step
	ET Type	Encoder Stepper Motor, 2 phase, micro step
Base Material (Notes5)		Aluminum, Extrusion type
Power source (Notes6)		100~230VAC, Single Phase, 50/60Hz
Weight		59Kg

Dimension

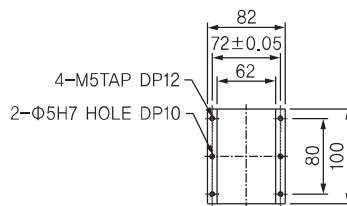
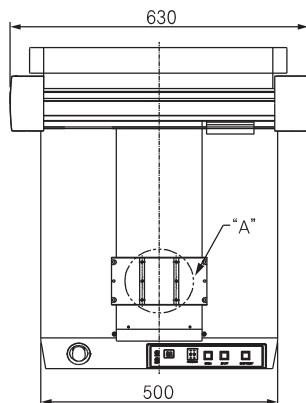

DETAIL "A"

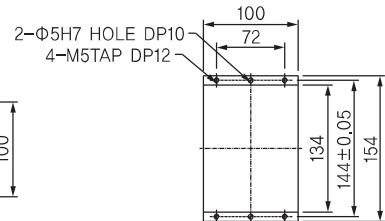

DETAIL "B"

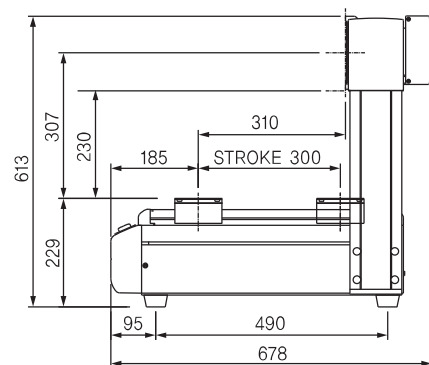
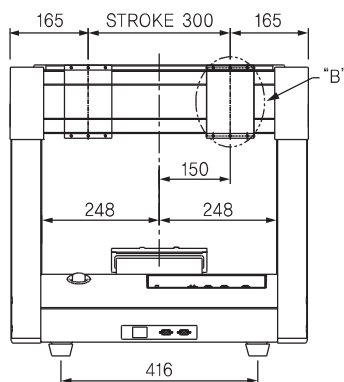

Applicable controllers

Controller	Maximum number of controlled axes	Page
Built-In	2 axes	157

Note

Refer to the page 100 for the detail explanations of (Note 1) to (Note 6)

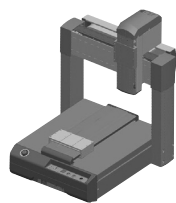
DTR3-3310T	Belt driven, Stroke 300x300x100, 3axes(XYZ), Aluminum Extrusion, Stepper Motor					
DTR3-3310ET	Belt driven, Stroke 300x300x100, 3axes(XYZ), Aluminum Extrusion, Encoder Stepper Motor					
Type : Stepper Motor	Arm length : XYZ	Payload : 10 kgf(Work) / 6 kgf(Tool)				
Type : Encoder Stepper Motor	Arm length : XYZ	Payload : 12 kgf(Work) / 7 kgf(Tool)				
Series	Axis	Stroke	Type	Option		
DTR	3	- 3310	- T	- SG		

Basic specifications

Series	Axis	Stroke(mm)				Motor Type	Maximum Payload(Kg)(Note1)		Maximum Speed(mm/s)			
		X	Y	Z	R		Work	Tool	X	Y	Z	R
DTR-T	3	300	300	100	-	Stepper Motor	10	6	500	500	250	-
DTR-ET	3	300	300	100	-	Encoder Stepper motor	12	7	800	800	400	-

Options

Code	Description
SG	Sigma software (General purpose)
EZ	Dispensing software
TZ	Screw fastening software
EIO	Extend IO(24/32)
EY	Extended height of Y axis

Common specifications

Positioning Repeatability(Notes2)		±0.01mm
Drive Type (Notes3)		Belt at X, Y axis, Ballscrew at Z Axis(Φ15, Lead10)
Motor (Notes4)	T Type	Stepper motor, 2 phase, micro step
	ET Type	Encoder Stepper Motor, 2 phase, micro step
Base Material (Notes5)		Aluminum, Extrusion type
Power source (Notes6)		100~230VAC, Single Phase, 50/60Hz
Weight		62Kg

Dimension

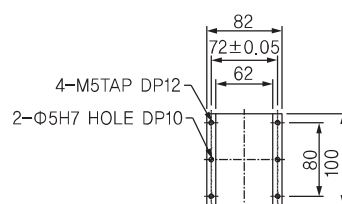
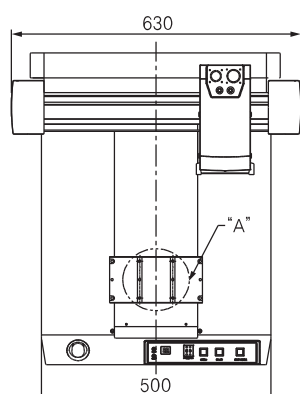

DETAIL "A"

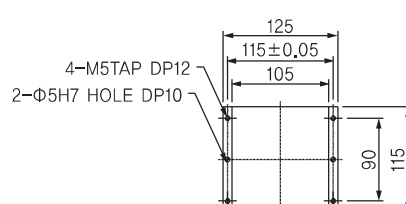

DETAIL "B"

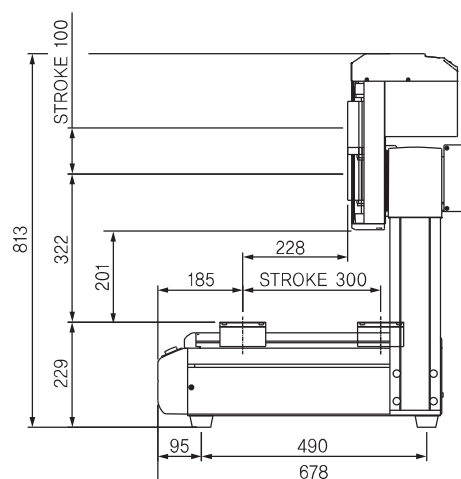
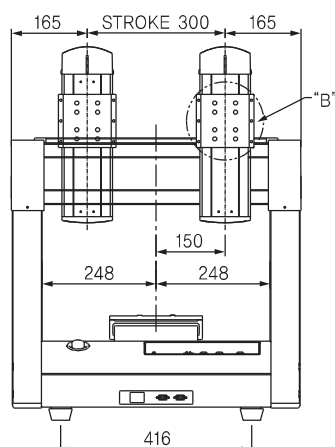

Applicable controllers

Controller	Maximum number of controlled axes	Page
Built-In	3 axes	157

Note

Refer to the page 100 for the detail explanations of (Note 1) to (Note 6)

DTR4-3310T	Belt driven, Stroke 300x300x100x360, 4axes(XYZR), Aluminum Extrusion, Stepper Motor				
DTR4-3310ET	Belt driven, Stroke 300x300x100x360, 4axes(XYZR), Aluminum Extrusion, Encoder Stepper Motor				
Type : Stepper Motor	Arm length : XYZR	Payload : 10 kgf(Work) / 2 kgf(Tool)			
Type : Encoder Stepper Motor	Arm length : XYZR	Payload : 12 kgf(Work) / 3 kgf(Tool)			
Series	Axis	Stroke	Type	Option	
DTR	4	- 3310	- T	- SG	

Basic specifications

Series	Axis	Stroke(mm)				Motor Type	Maximum Payload(Kg)(Note1)		Maximum Speed(mm/s)			
		X	Y	Z	R		Work	Tool	X	Y	Z	R
DTR-T	4	300	300	100	360°	Stepper Motor	10	2	500	500	250	600°/s
DTR-ET	4	300	300	100	360°	Encoder Stepper motor	12	3	800	800	400	720°/s

Options

Code	Description
SG	Sigma software (General purpose)
EZ	Dispensing software
TZ	Screw fastening software
EIO	Extend IO(24/32)
EY	Extended height of Y axis

Common specifications

Positioning Repeatability(Note2)		±0.01mm
Drive Type (Note3)		Belt at X, Y axis, Ballscrew at Z Axis(Φ15, Lead10)
Motor (Note4)	T Type	Stepper motor, 2 phase, micro step
	ET Type	Encoder Stepper Motor, 2 phase, micro step
Base Material (Note5)		Aluminum, Extrusion type
Power source (Note6)		100~230VAC, Single Phase, 50/60Hz
Weight		66Kg

Dimension

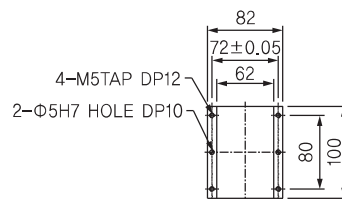
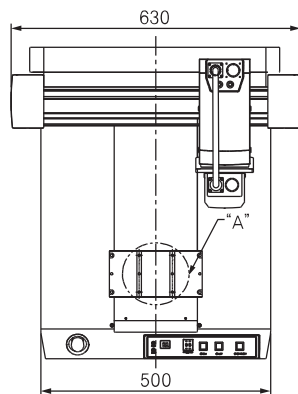

DETAIL "A"

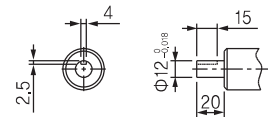

DETAIL "B"

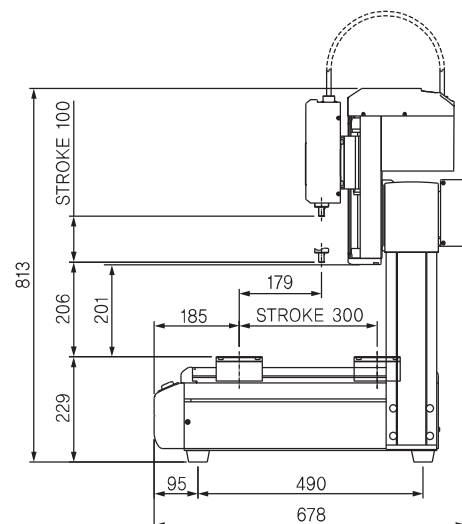
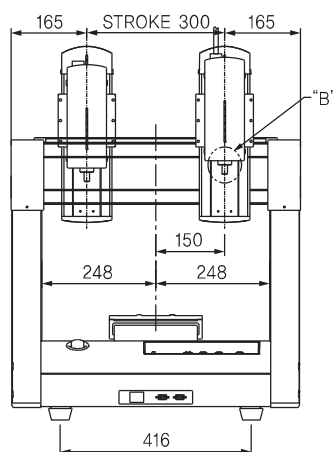

Applicable controllers

Controller	Maximum number of controlled axes	Page
Built-In	4 axes	157

Note

Refer to the page 100 for the detail explanations of (Note 1) to (Note 6)

DTR2-4410T

Belt driven, Stroke 400x400, 2axes(XY), Aluminum Extrusion, Stepper Motor

DTR2-4410ET

Belt driven, Stroke 400x400, 2axes(XY), Aluminum Extrusion, Encoder Stepper Motor

Type : Stepper Motor

Arm length : XY

Payload : 10 kgf(Work) / 10 kgf(Tool)

Type : Encoder Stepper Motor

Arm length : XY

Payload : 12 kgf(Work) / 12 kgf(Tool)

Series	Axis	Stroke	Type	Option
DTR	2	- 4410	- T	- SG

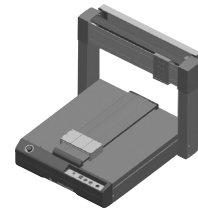

Basic specifications

Series	Axis	Stroke(mm)				Motor Type	Maximum Payload(Kg)(Note1)		Maximum Speed(mm/s)			
		X	Y	Z	R		Work	Tool	X	Y	Z	R
DTR-T	2	400	400	-	-	Stepper Motor	10	10	500	500	-	-
DTR-ET	2	400	400	-	-	Encoder Stepper motor	12	12	800	800	-	-

Options

Code	Description
SG	Sigma software (General purpose)
EZ	Dispensing software
TZ	Screw fastening software
EIO	Extend IO(24/32)
EY	Extended height of Y axis

Common specifications

Positioning Repeatability(Note2)		±0.01mm
Drive Type (Note3)		Belt at X, Y Axis
Motor (Note4)	T Type	Stepper motor, 2 phase, micro step
	ET Type	Encoder Stepper Motor, 2 phase, micro step
Base Material (Note5)		Aluminum, Extrusion type
Power source (Note6)		100~230VAC, Single Phase, 50/60Hz
Weight		67Kg

Dimension

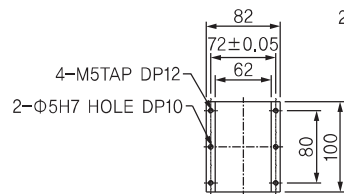
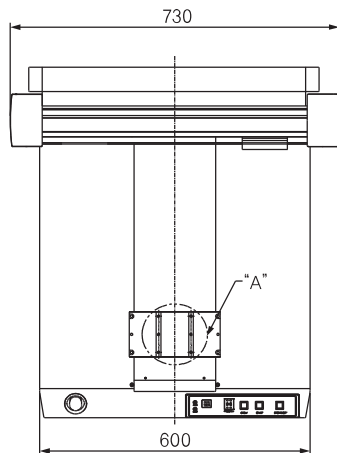

DETAIL "A"

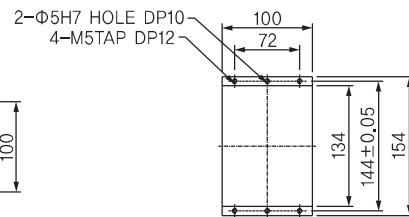

DETAIL "B"

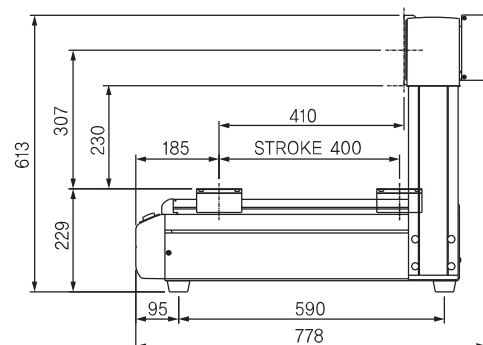
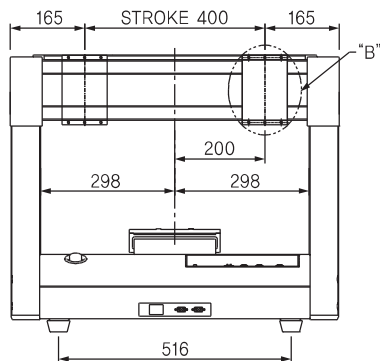

Applicable controllers

Controller	Maximum number of controlled axes	Page
Built-In	2 axes	157

Note

Refer to the page 100 for the detail explanations of (Note 1) to (Note 6)

DTR3-4410T	Belt driven, Stroke 400x400x100, 3axes(XYZ), Aluminum Extrusion, Stepper Motor			
DTR3-4410ET	Belt driven, Stroke 400x400x100, 3axes(XYZ), Aluminum Extrusion, Encoder Stepper Motor			
Type : Stepper Motor	Arm length : XYZ	Payload : 10 kgf(Work) / 6 kgf(Tool)		
Type : Encoder Stepper Motor	Arm length : XYZ	Payload : 12 kgf(Work) / 7 kgf(Tool)		
Series	Axis	Stroke	Type	Option
DTR	3	- 4410	- T	- SG



Basic specifications

Series	Axis	Stroke(mm)				Motor Type	Maximum Payload(Kg)(Note1)		Maximum Speed(mm/s)			
		X	Y	Z	R		Work	Tool	X	Y	Z	R
DTR-T	3	400	400	100	-	Stepper Motor	10	6	500	500	250	-
DTR-ET	3	400	400	100	-	Encoder Stepper motor	12	7	800	800	400	-

Options

Code	Description
SG	Sigma software (General purpose)
EZ	Dispensing software
TZ	Screw fastening software
EIO	Extend IO(24/32)
EY	Extended height of Y axis

Common specifications

Positioning Repeatability(Note2)		±0.01mm
Drive Type (Note3)		Belt at X, Y axis, Ballscrew at Z Axis(Φ15, Lead10)
Motor (Note4)	T Type	Stepper motor, 2 phase, micro step
	ET Type	Encoder Stepper Motor, 2 phase, micro step
Base Material (Note5)		Aluminum, Extrusion type
Power source (Note6)		100~230VAC, Single Phase, 50/60Hz
Weight		70Kg

Dimension

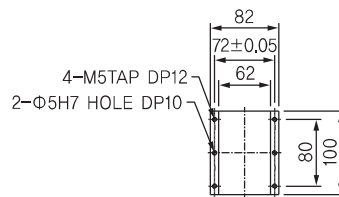
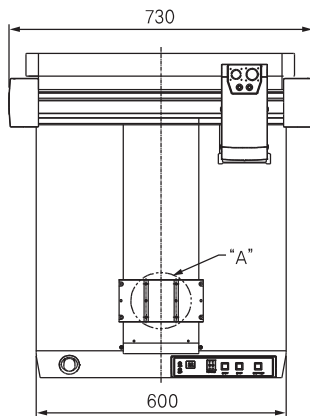

DETAIL "A"

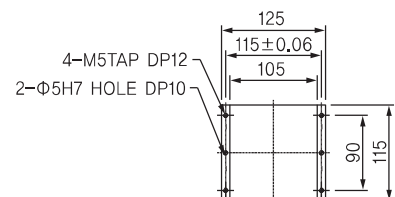

DETAIL "B"

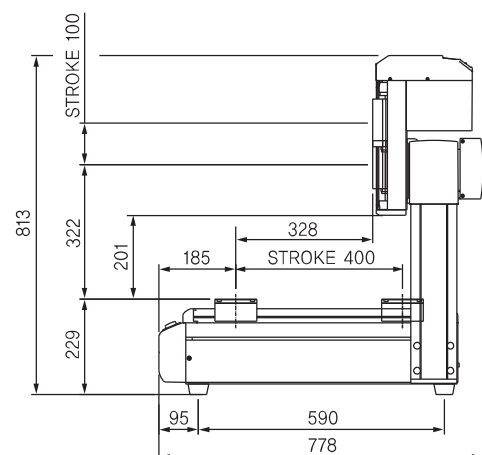
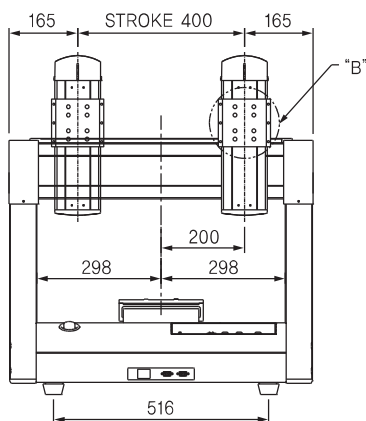

Applicable controllers

Controller	Maximum number of controlled axes	Page
Built-In	3 axes	157

Note

Refer to the page 100 for the detail explanations of (Note 1) to (Note 6)

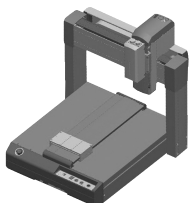
DTR4-4410T	Belt driven, Stroke 400x400x100x360, 4axes(XYZR), Aluminum Extrusion, Stepper Motor				
DTR4-4410ET	Belt driven, Stroke 400x400x100x360, 4axes(XYZR), Aluminum Extrusion, Encoder Stepper Motor				
Type : Stepper Motor	Arm length : XYZR	Payload : 10 kgf(Work) / 2 kgf(Tool)			
Type : Encoder Stepper Motor	Arm length : XYZR	Payload : 12 kgf(Work) / 3 kgf(Tool)			
Series	Axis	Stroke	Type	Option	
DTR	4	- 4410	- T	- SG	

Basic specifications

Series	Axis	Stroke(mm)				Motor Type	Maximum Payload(Kg)(Note1)		Maximum Speed(mm/s)			
		X	Y	Z	R		Work	Tool	X	Y	Z	R
DTR-T	4	400	400	100	360°	Stepper Motor	10	2	500	500	250	600°/s
DTR-ET	4	400	400	100	360°	Encoder Stepper motor	12	3	800	800	400	720°/s

Options

Code	Description
SG	Sigma software (General purpose)
EZ	Dispensing software
TZ	Screw fastening software
EIO	Extend IO(24/32)
EY	Extended height of Y axis

Common specifications

Positioning Repeatability(Note2)		±0.01mm
Drive Type (Note3)		Belt at X, Y axis, Ballscrew at Z Axis(Φ15, Lead10)
Motor (Note4)	T Type	Stepper motor, 2 phase, micro step
	ET Type	Encoder Stepper Motor, 2 phase, micro step
Base Material (Note5)		Aluminum, Extrusion type
Power source (Note6)		100~230VAC, Single Phase, 50/60Hz
Weight		74Kg

Dimension

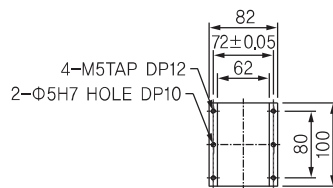
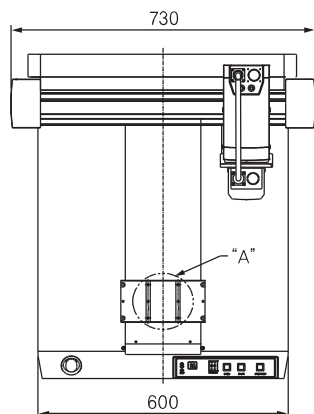

DETAIL "A"

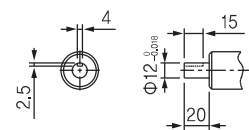

DETAIL "B"

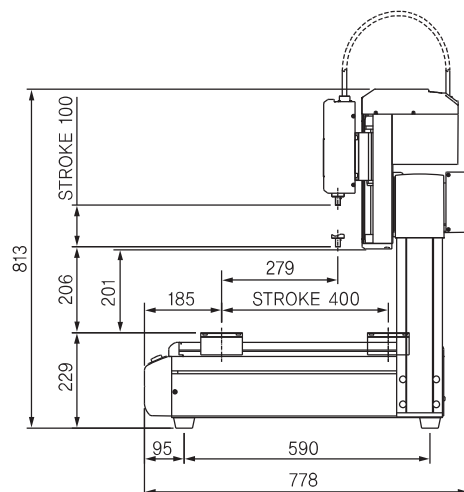
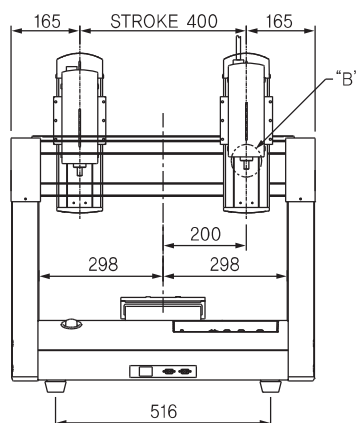

Applicable controllers

Controller	Maximum number of controlled axes	Page
Built-In	4 axes	157

Note

Refer to the page 100 for the detail explanations of (Note 1) to (Note 6)

DTR2-3310S

Ball screw driven, Servo motor, Stroke 300x300, 2axes(XY), Aluminum Extrusion

Type : Servo motor

Axis : XY

Payload : 15Kg(Work), 15Kg(Tool)

Series Axis Stroke Type Option
DTR 2 - 3310 - S - SG

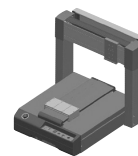

Basic specifications

Series	Axis	Stroke(mm)				Motor Type	Maximum Payload(Kg)(Note1)		Maximum Speed(mm/s)			
		X	Y	Z	R		Work	Tool	X	Y	Z	R
DTR	2	300	300	-	-	Servo motor	15	15	500	500	-	-

Options

Code	Description
SG	Sigma software(General purpose)
EZ	Dispensing software
TZ	Screw fastening software
EIO	Extended IO(24/32)
EY	Extended height of Y axis

Common specifications

Positioning Repeatability(Note2)	±0.01mm
Drive type(Note3)	Ball screw, X,Y axis(Φ15, Lead 10mm)
Motor(Note4)	Servo motor
Encoder type	Incremental
Base material(Note5)	Aluminum, Extrusion type
Power source(Note6)	100~230VAC, Single phase, 50/60Hz
Weight	62kg

Dimension

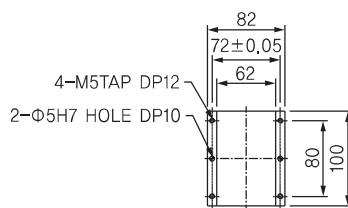
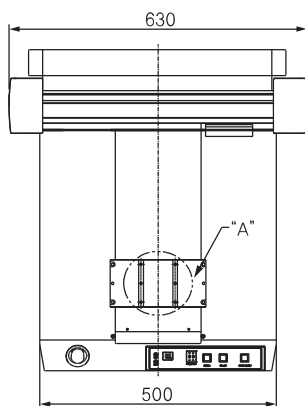

DETAIL "A"

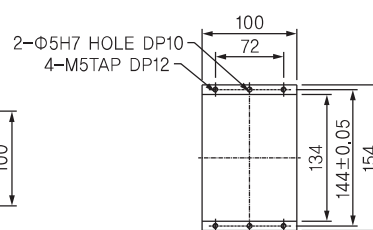

DETAIL "B"

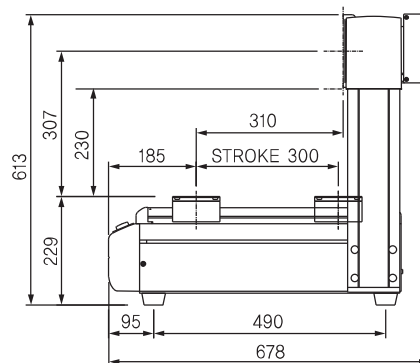
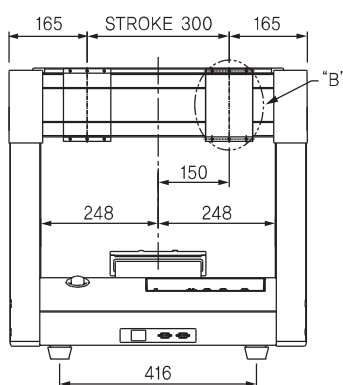

Applicable controllers

Controller	Maximum number of controlled axes	Page
Built-In	2 axes	157

Note

Refer to the page 100 for the detail explanations of (Note 1) to (Note 6)

DTR3-3310S

Ball screw driven, Servo motor, Stroke 300×300×100, 3 axes(XYZ), Aluminum Extrusion

Type : Servo motor

Axis : XYZ

Payload : 15Kg(Work), 7Kg(Tool)

Series

DTR

Axis

3

Stroke

3310

Type

S

Option

SG



Basic specifications

Series	Axis	Stroke(mm)				Motor Type	Maximum Payload(Kg) ^(Note1)		Maximum Speed(mm/s)			
		X	Y	Z	R		Work	Tool	X	Y	Z	R
DTR	3	300	300	100	-	Servo motor	15	7	500	500	250	-

Options

Code	Description
SG	Sigma software(General purpose)
EZ	Dispensing software
TZ	Screw fastening software
EIO	Extended IO(24/32)
EY	Extended height of Y axis

Common specifications

Positioning Repeatability ^(Note2)	±0.01mm
Drive type ^(Note3)	Ball screw, X,Y,Z axis(Φ15, Lead 10mm)
Motor ^(Note4)	Servo motor
Encoder type	Incremental
Base material ^(Note5)	Aluminum, Extrusion type
Power source ^(Note6)	100~230VAC, Single phase, 50/60Hz
Weight	67kg

Dimension

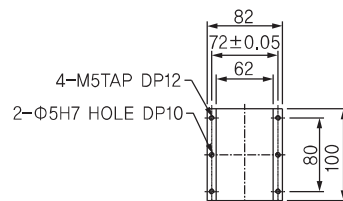
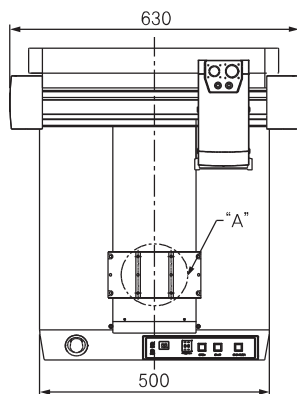

DETAIL "A"

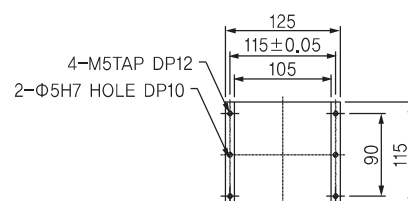

DETAIL "B"

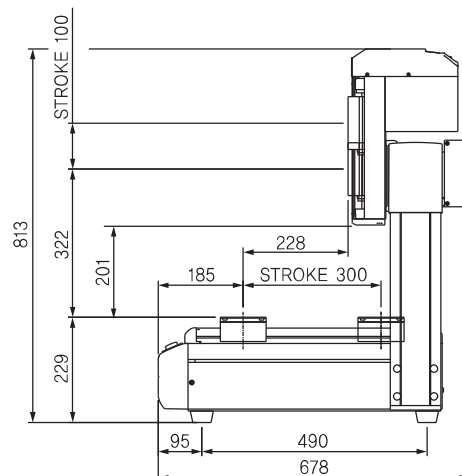
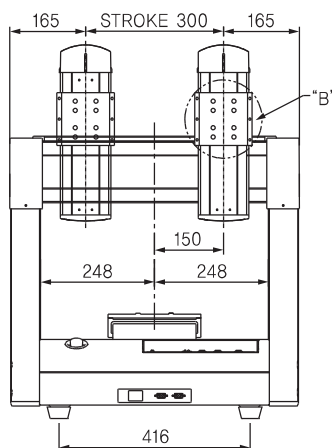

Applicable controllers

Controller	Maximum number of controlled axes	Page
Built-In	3 axes	157

Note

Refer to the page 100 for the detail explanations of (Note 1) to (Note 6)

DTR4-3310S

Ball screw driven, Servo motor, Stroke 300×300×100×360, 4axes(XYZR), Aluminum Extrusion

Type : Servo motor

Axis : XYZR

Payload : 15Kg(Work), 2Kg(Tool)

Series Axis Stroke Type Option
DTR 4 - 3310 - S - SG



Basic specifications

Series	Axis	Stroke(mm)				Motor Type	Maximum Payload(Kg)(Note1)		Maximum Speed(mm/s)			
		X	Y	Z	R		Work	Tool	X	Y	Z	R
DTR	4	300	300	100	360°	Servo motor	15	2	500	500	250	600°

Options

Code	Description
SG	Sigma software(General purpose)
EZ	Dispensing software
TZ	Screw fastening software
EIO	Extended IO(24/32)
EY	Extended height of Y axis

Common specifications

Positioning Repeatability(Note2)	±0.01mm
Drive type(Note3)	Ball screw, X,Y,Z axis(Φ15, Lead 10mm)
Motor(Note4)	Servo motor
Encoder type	Incremental
Base material(Note5)	Aluminum, Extrusion type
Power source(Note6)	100~230VAC, Single phase, 50/60Hz
Weight	71kg

Dimension

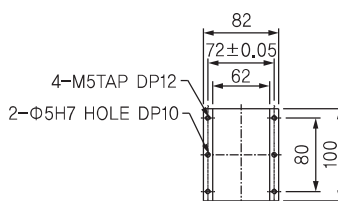
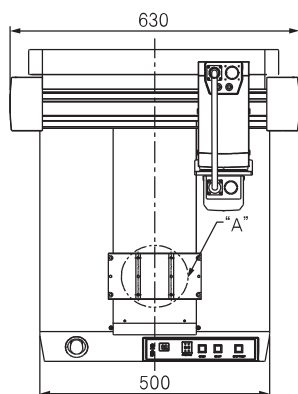

DETAIL "A"

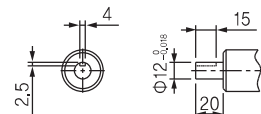

DETAIL "B"

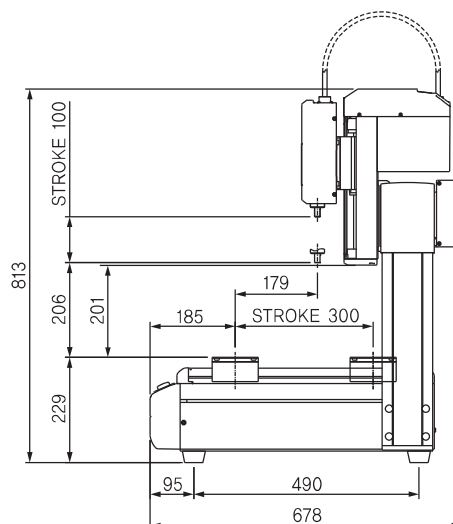
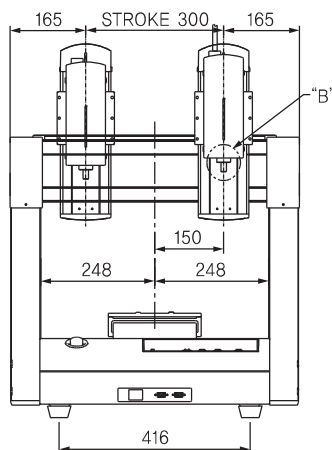

Applicable controllers

Controller	Maximum number of controlled axes	Page
Built-In	4 axes	157

Note

Refer to the page 100 for the detail explanations of (Note 1) to (Note 6)

DTR2-4410S

Ball screw driven, Servo motor, Stroke 400×400, 2axes(XY), Aluminum Extrusion

Type : Servo motor

Axis : XY

Payload : 15Kg(Work), 15Kg(Tool)

Series

DTR

Axis

2

Stroke

4410

Type

S

Option

SG



Basic specifications

Series	Axis	Stroke(mm)				Motor Type	Maximum Payload(Kg) ^(Note1)		Maximum Speed(mm/s)			
		X	Y	Z	R		Work	Tool	X	Y	Z	R
DTR	2	400	400	-	-	Servo motor	15	15	500	500	-	-

Options

Code	Description
SG	Sigma software(General purpose)
EZ	Dispensing software
TZ	Screw fastening software
EIO	Extended IO(24/32)
EY	Extended height of Y axis

Common specifications

Positioning Repeatability ^(Note2)	±0.01mm
Drive type ^(Note3)	Ball screw, X, Y axis(Φ15, Lead 10mm)
Motor ^(Note4)	Servo motor
Encoder type	Incremental
Base material ^(Note5)	Aluminum, Extrusion type
Power source ^(Note6)	100~230VAC, Single phase, 50/60Hz
Weight	70kg

Dimension

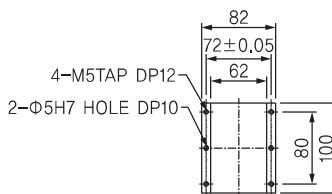
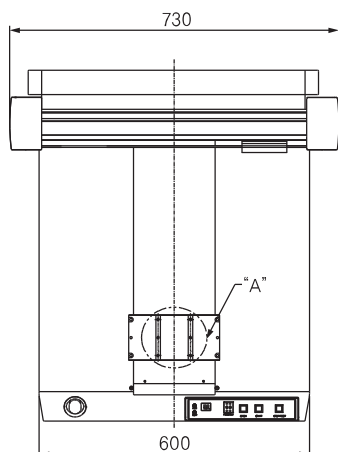

DETAIL "A"

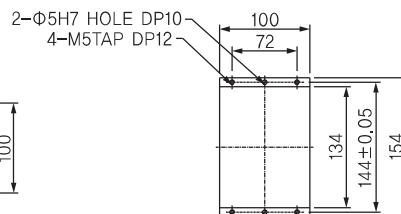

DETAIL "B"

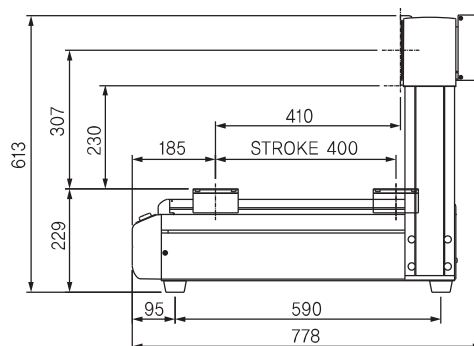
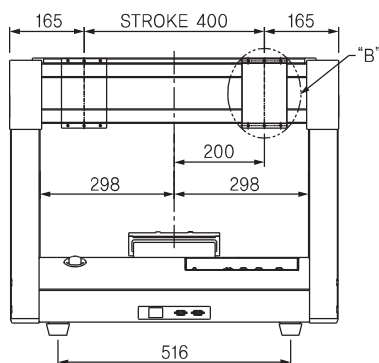

Applicable controllers

Controller	Maximum number of controlled axes	Page
Built-In	2 axes	157

Note

Refer to the page 100 for the detail explanations of (Note 1) to (Note 6)

DTR3-4410S

Ball screw driven, Servo motor, Stroke 400×400×100, 3 axes(XYZ), Aluminum Extrusion

Type : Servo motor

Axis : XYZ

Payload : 15Kg(Work), 7Kg(Tool)

Series Axis Stroke Type Option
DTR 3 - 4410 - S - SG

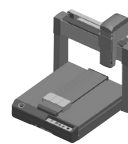

Basic specifications

Series	Axis	Stroke(mm)				Motor Type	Maximum Payload(Kg)(Note1)		Maximum Speed(mm/s)			
		X	Y	Z	R		Work	Tool	X	Y	Z	R
DTR	3	400	400	100	-	Servo motor	15	7	500	500	250	-

Options

Code	Description
SG	Sigma software(General purpose)
EZ	Dispensing software
TZ	Screw fastening software
EIO	Extended IO(24/32)
EY	Extended height of Y axis

Common specifications

Positioning Repeatability(Note2)	±0.01mm
Drive type(Note3)	Ball screw, X,Y,Z axis(Φ15, Lead 10mm)
Motor(Note4)	Servo motor
Encoder type	Incremental
Base material(Note5)	Aluminum, Extrusion type
Power source(Note6)	100~230VAC, Single phase, 50/60Hz
Weight	75kg

Dimension

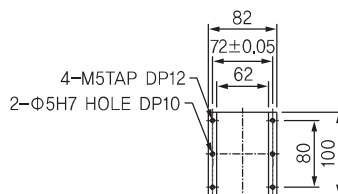
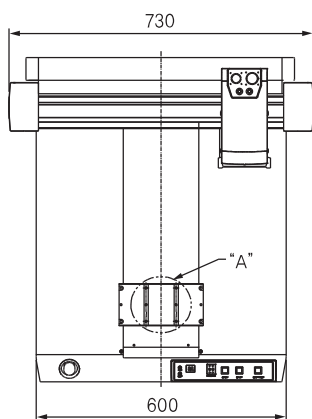

DETAIL "A"

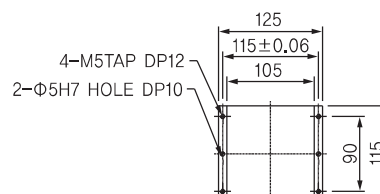

DETAIL "B"

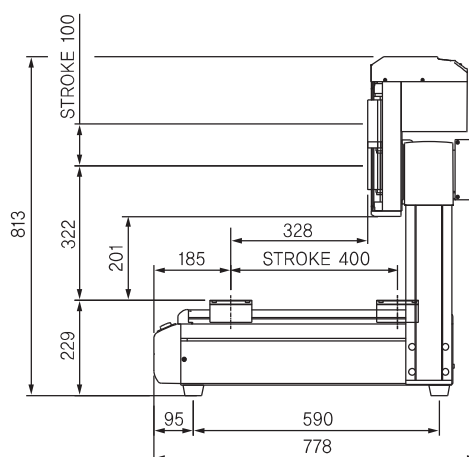
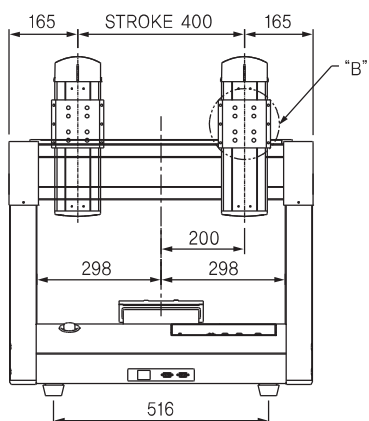

Applicable controllers

Controller	Maximum number of controlled axes	Page
Built-In	3 axes	157

Note

Refer to the page 100 for the detail explanations of (Note 1) to (Note 6)

DTR4-4410S

Ball screw driven, Servo motor, Stroke 400×400×100×360, 4axes(XYZR), Aluminum Extrusion

Type : Servo motor

Axis : XYZR

Payload : 15Kg(Work), 2Kg(Tool)

Series

DTR

Axis

4

Stroke

4410

Type

S

Option

SG

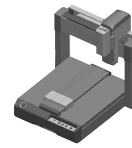

Basic specifications

Series	Axis	Stroke(mm)				Motor Type	Maximum Payload(Kg)(Note1)		Maximum Speed(mm/s)			
		X	Y	Z	R		Work	Tool	X	Y	Z	R
DTR	4	400	400	100	360°	Servo motor	15	2	500	500	250	600°

Options

Code	Description
SG	Sigma software(General purpose)
EZ	Dispensing software
TZ	Screw fastening software
EIO	Extended IO(24/32)
EY	Extended height of Y axis

Common specifications

Positioning Repeatability(Note2)	±0.01mm
Drive type(Note3)	Ball screw, X,Y,Z axis(Φ15, Lead 10mm)
Motor(Note4)	Servo motor
Encoder type	Incremental
Base material(Note5)	Aluminum, Extrusion type
Power source(Note6)	100~230VAC, Single phase, 50/60Hz
Weight	79kg

Dimension

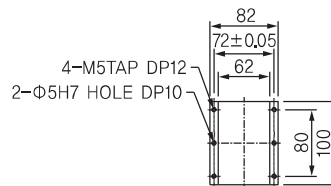
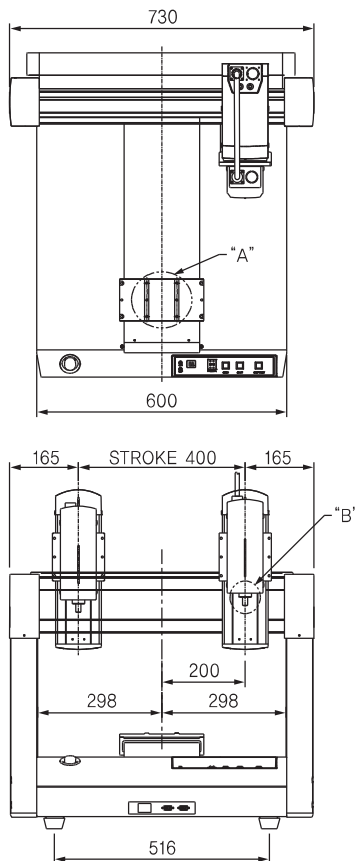

DETAIL "A"

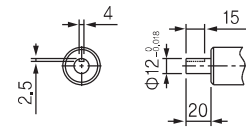

DETAIL "B"

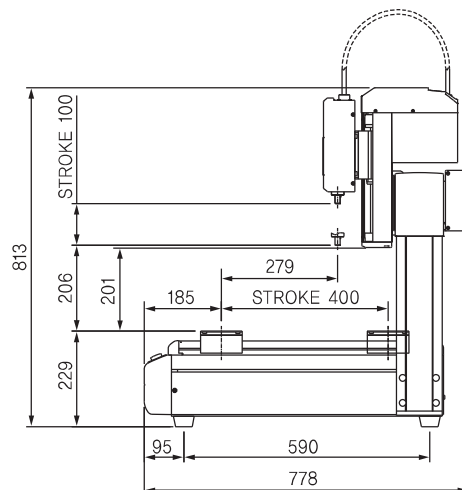

Applicable controllers

Controller	Maximum number of controlled axes	Page
Built-In	4 axes	157

Note

Refer to the page 100 for the detail explanations of (Note 1) to (Note 6)

DTR4-3510S

Ball screw driven, Servo motor, Dual-X axes, Stroke 300×300×500×100, 4axes(X1X2YZ), Aluminum Casting

Type : Servo motor

Axis : X1X2YZ

Payload : 15Kg(Work), 7Kg(Tool)

Series Axis Stroke Type Option
DTR 4 - 3510 - S - SG



Basic specifications

Series	Axis	Stroke(mm)				Motor Type	Maximum Payload(Kg)(Note1)		Maximum Speed(mm/s)			
		X1	X2	Y	Z		Work	Tool	X1	X2	Y	Z
DTR	4	300	300	500	100	Servo motor	15	7	500	500	500	250

Options

Code	Description
SG	Sigma software(General purpose)
EZ	Dispensing software
TZ	Screw fastening software
EIO	Extended IO(24/32)
EY	Extended height of Y axis

Common specifications

Positioning Repeatability(Note2)	±0.01mm
Drive type(Note3)	Ball screw, X1, X2, Y, Z axis(Φ15, Lead 10mm)
Motor(Note4)	Servo motor
Encoder type	Incremental
Base material(Note5)	Aluminum, Casting type
Power source(Note6)	200~230VAC, Single phase, 50/60Hz
Weight	82kg

Dimension

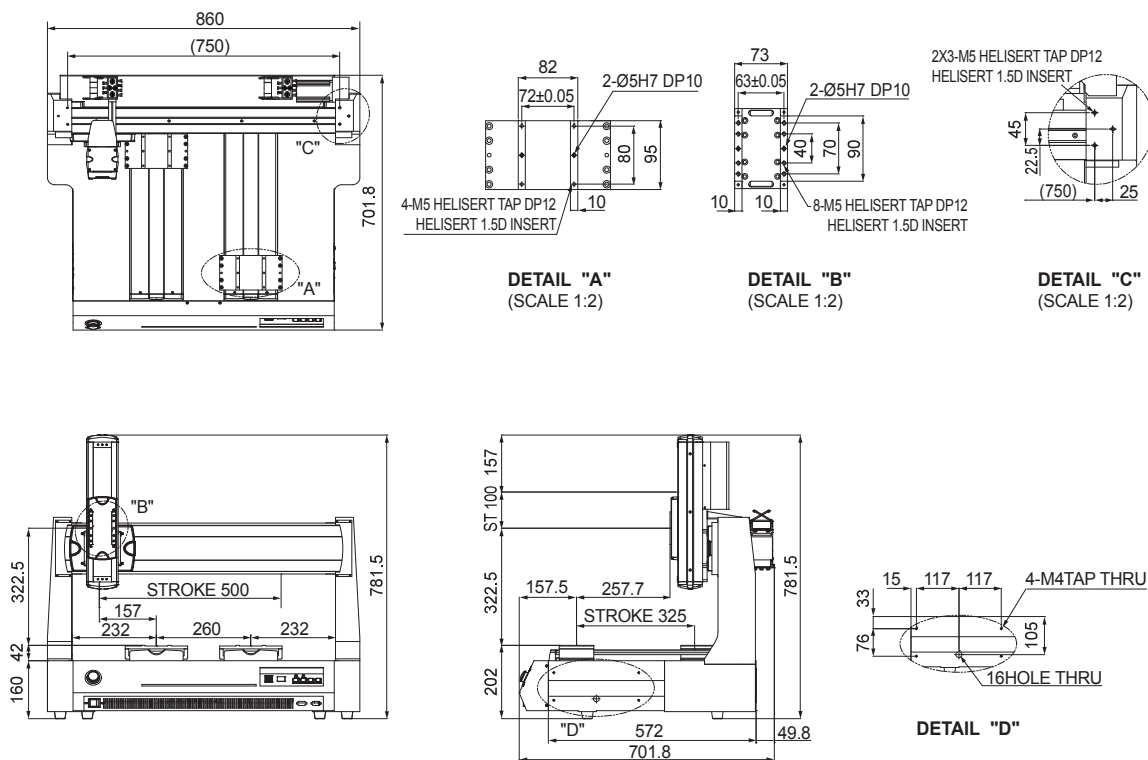

Applicable controllers

Controller	Maximum number of controlled axes	Page
Built-In	4 axes	157

Note

Refer to the page 100 for the detail explanations of (Note 1) to (Note 6)